



# Pool **MIRAGE** oval

---

Specific instruction sheet

**Note :** This instruction sheet manual includes installation instructions for specific items related to the MIRAGE OVAL pool. All the other steps must be followed in the main instruction manual.

## 1- SUPPORT POSTS INSTALLATION

Insert the upright base on the front part of the bottom plate (figure 1.1).

Secure that in place with a 1 ½ inch screw in the upright base opening.

Put the top of the upright on the wall and insert the wall channel clips. These clips tighten on the top of the upright by simple pressure and links the wall, the top channel and the post. (figure 1.2 and 1.3)

Then insert the base cover at the bottom of the upright. (figure 1.4)

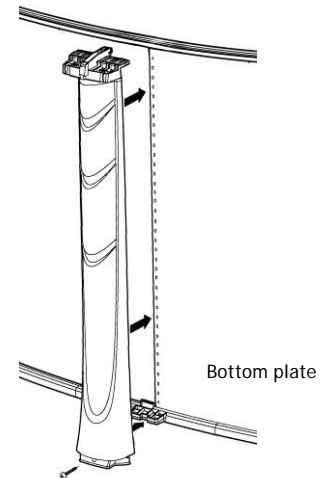

Figure 1.1

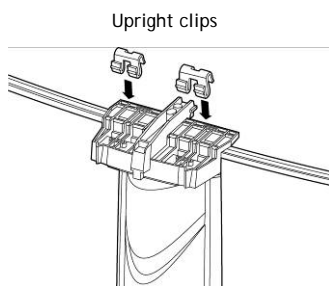

Figure 1.2

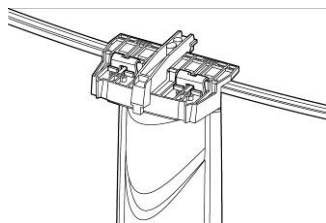

Figure 1.3

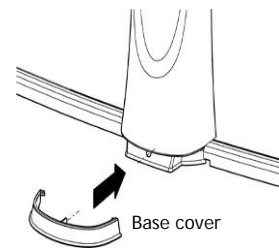

Figure 1.4

## 2- TOP RAILS INSTALLATION

Position and place the top rails as indicated in (figure 2.1). The slots on the top rails should line up with the holes on the joining plates. Insert the top 3/4-inch screws (S) without tightening them too much.

Even the space of each top seat ends to make sure it is centered between the uprights.

When all the top rails are installed, wait and fill the pool 2 feet from the top before continuing to the other step.

**Be sure that the two axis of the uprights are levelled by pushing gently to the inside before tightening the screws permanently.**

Put the front screws (S) in the lower ends of the top seat and be sure to always keep levelled the two axis of the post.

Install all necessary equipment (i.e. skimmer, filter, etc) per manufacturers specifications.

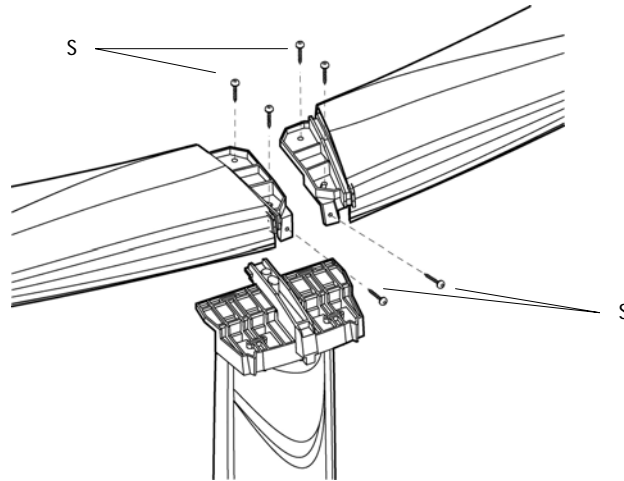

Figure 2.1

## 3- SEAT CAP INSTALLATION (\*)

Put the rigid cap on the soft one. Align the ellipses of the soft cap with the holes of the rigid cap. (figure 3.1)

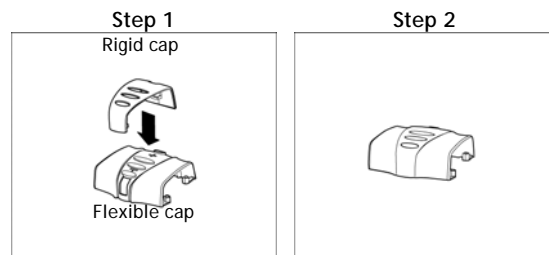
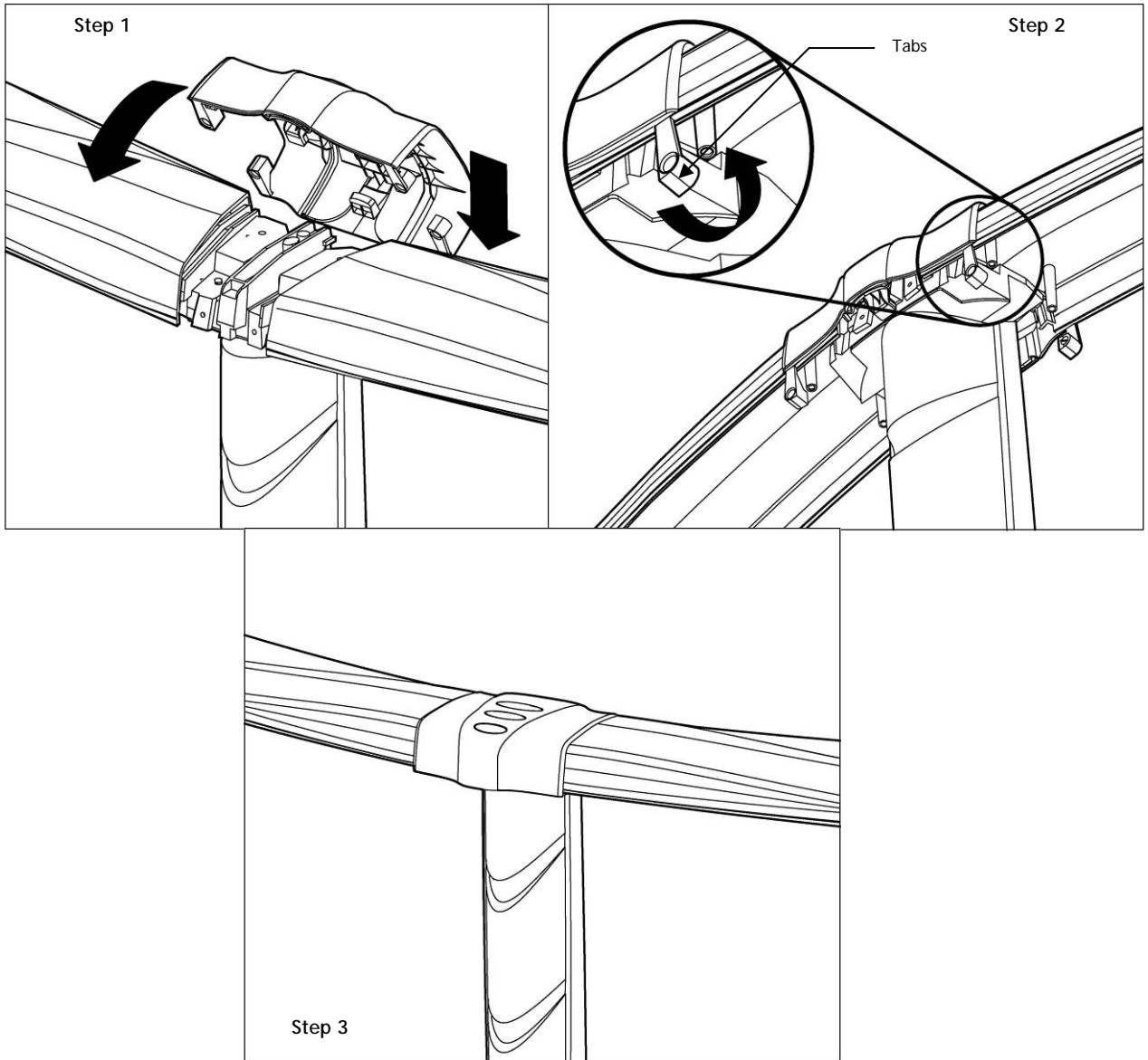

Figure 3.1

\*Note. The two parts of the seat cap will normally be pre-assembled

#### 4- SEAT CAPS INSTALLATION ON THE POOL STRUCTURE

Insert the rear central hook (inside of the pool) of the rigid cap on the center tab of the upright. Install the seat cap on the front by pulling gently on the part. That will enable the part to lock on the front tab of the upright. Be sure that the soft part sits well on the top seats. Then insert the four tabs of the soft part over the cylinders under the top seat.



## 4- PARTS LIST

Description	Piece number	12 x 18	12 x 21	12 x 24	15 x 28	15 x 33	18 x 36
A- Top wall channel (Round section)							
12 x 21	10725_ _100	8	8	8	-	-	-
15 x 28, 15 x 33		-	-	-	10	10	-
18 x 36	10758_ _100	-	-	-	-	-	12
B- Bottom wall channel (Round section)							
12 x 21	10825_ _200	8	8	8	-	-	-
15 x 28, 15 x 33		-	-	-	10	10	-
18 x 36	10858_ _200	-	-	-	-	-	12
C- Top wall channel (Straight side section)							
Top wall channel	10730_ _101	2	4	6	8	12	12
D- Top transition channel * (End of straight side section)							
End channel	10700_ _102	4	4	4	4	4	4
E- Bottom wall channel (Straight side section)							
Bottom wall channel	10830_ _101	2	4	6	8	12	12
F- Bottom wall channel transition † without plate (End of straight Bottom wall channel	10830_ _102	2	2	2	2	2	2
G- bottom wall channel transition † with plate (End of straight section) Bottom wall channel	10830_ _201	2	2	2	2	2	2
I- Steel wall							
Steel wall (end-to-end)	109_ _ _ K52	49' 11-1/2"	55' 2"	60' 3-1/2"	74'	84' 5/8"	92' 10"
J-Liner							
Vinyl liner (hook)		1	1	1	1	1	1
Vinyl liner (overlap)		1	1	1	1	1	1
K- Plastic coping (not included)							
Plastic coping 36 in.	6COP40000000	17	19	21	25	28	32
L- Support post							
Support post	10200_ _ K_ _	10	10	10	12	12	14
M- Top seat							
Curved top seat 53"	10100_ _ K00	8	8	8	10	10	12
N- Rigid seat cap							
Rigid seat cap	10300_ _ K00	14	16	18	22	26	28
O- Flexible seat cap							
Flexible seat cap	10600_ _ K00	14	16	18	22	26	28
P- Base cover							
Base cover	11700_ _ K00	10	10	10	12	12	14
Q- Channel clip							
Channel clip	6ADP10900A00	20	20	20	24	24	28
S- 3/4" screw							
Stainless steel screw 12 x 3/4"	2PPS124	84	96	108	132	156	168
T- 1 1/2" screw							
Stainless steel screw 12 x 1 1/2"	2PPS112	10	10	10	12	12	14
U- Top seat							
Straight top seat 29"	10100_ _ K70	6	8	10	12	16	16

Description	Piece number	12 x 18	12 x 21	12 x 24	15 x 28	15 x 33	18 x 36
V- Upright cover							
Upright cover 52"	102__000002	4	6	8	10	14	14
Upright cover 54"	102__000004	4	6	8	10	14	14
W- Logos							
Logo Aqua Leader	130__000010	4	6	8	10	14	14
Logo plain	130__000000	4	6	8	10	14	14
X- Pressure plate							
Steel pressure plate	2ANG030	4	6	8	10	14	14
Y- Strap end channel							
Steel strap end channel	2SEC000	4	6	8	10	14	14
Z- Under channel							
Steel under channel	2UCH000	4	6	8	10	14	14
AA- Straps							
Straps 12'	2BDM012	4	6	8	-	-	-
Straps 15'	2BDM015	-	-	-	15	21	-
Straps 18'	2BDM018	-	-	-	-	-	21
BB- Washer 3 holes							
Washer 3 holes	2PLA000	8	12	16	20	28	28
CC- Upright							
Steel upright 52"	2REN200	4	6	8	10	14	14
Steel upright 54"	2REN400	4	6	8	10	14	14
DD- Gussets							
Right gusset	2GUR000	4	6	8	10	14	14
Left gusset	2GUL000	4	6	8	10	14	14
EE- Top plate							
Metal top plate	2MTP000	4	6	8	10	14	14
FF- Top plate							
Resin top plate	1040033K01	4	6	8	10	14	14
GG- Bottom plate							
Resin bottom plate straight section	104__000000	4	6	8	10	14	14
HH- Bolt 5"							
Bolt 5" x 5/16 - 18	2PCB518	24	36	48	60	84	84
II- Bolt 4 1/2"							
Bolt 4 1/2" x 5/16 - 18	2PCB418	8	12	16	20	28	28
JJ- Nut							
Nut 5/16 - 18	2PNZ518	44	66	88	120	168	168
KK- Screw 1/2"							
Screw 1/2" x 5/16 - 18	2PPS002	12	18	24	40	56	56
LL- Screw 1/2"							
Screw 1/2" #10	2PPS001	28	42	56	70	98	98
MM- Screw 3/4"							
Screw 3/4" #12 truss head	2TPS124	18	30	42	54	78	78
NN- Screw 1"							
Screw 1" #10	2PPS004	16	24	32	40	56	56
OO- Bolt 5 1/2" **							
Bolt 5 1/2" x 1/4 - 20	2PCB520	4	6	8	10	14	14
PP- Nut **							
Nut 1/4 - 20	2PCB420	4	6	8	10	14	14

Piece number codification

Example :

109 24 09 K 52  
Wall Diameter Color Model Height

Color codes : 02=pearl, 08 Ivory, 09 Champagne, 10 green, 33 grey

\* The transition top channel is the same type as the one in the straight section, but with 2 inches longer. (Not illustrated)

† The transition bottom channels are 2 inches longer than the one of the straight side section. (Not illustrated)

\*\* Used to hold the upright cover at the base (Not illustrated)

## EXPLODED VIEW

Round section

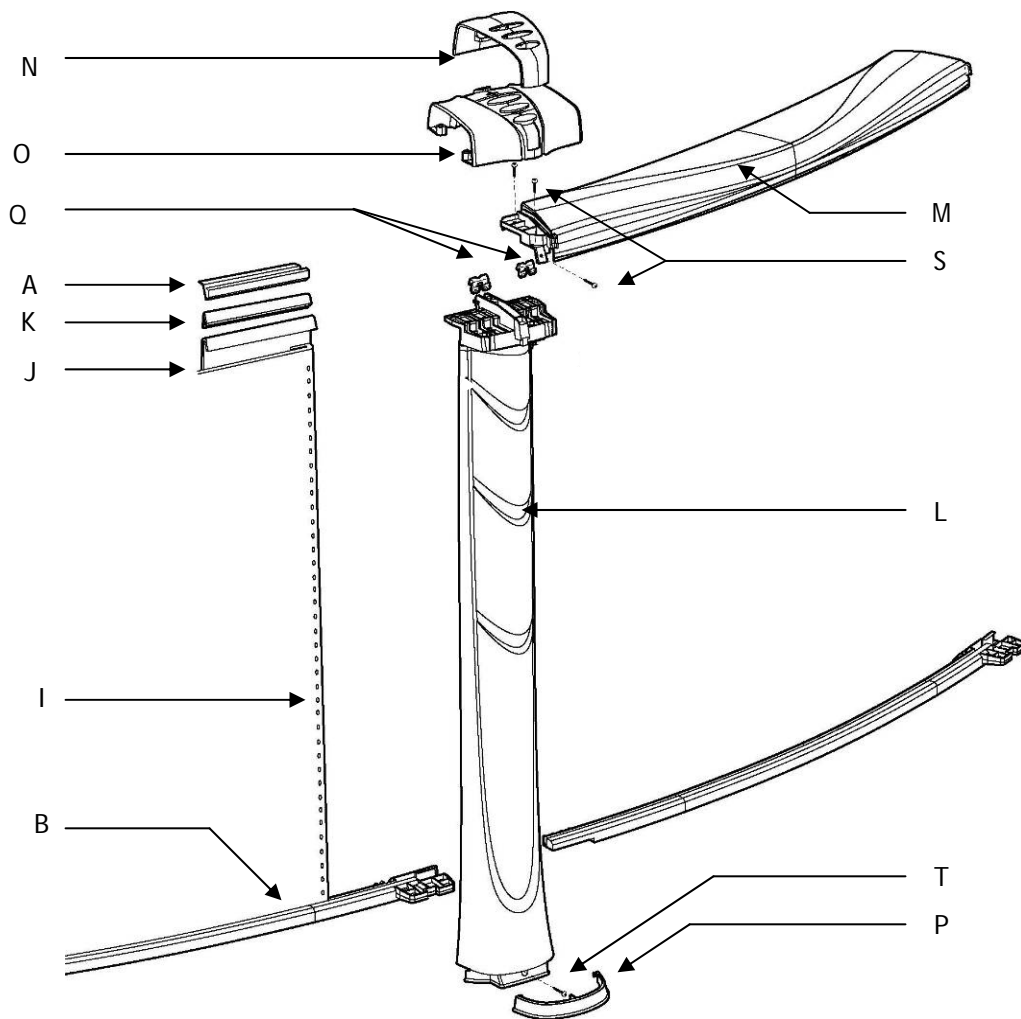



## Real sizes

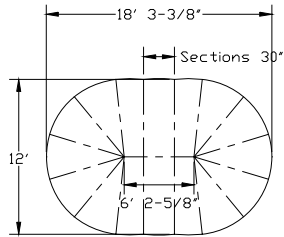

Oval Pool "Contour system" 12' X 18'

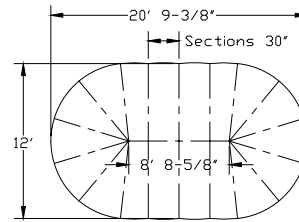

Oval Pool "Contour system" 12' X 21'

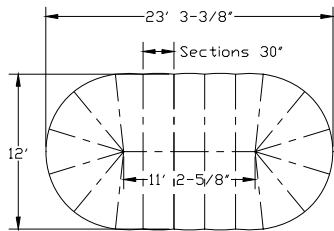

Oval Pool "Contour system" 12' X 24'

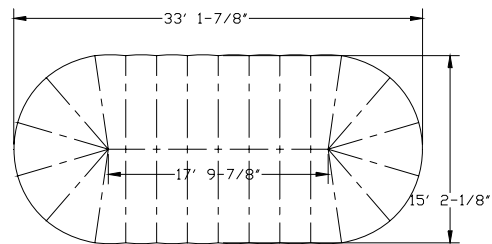

Oval Pool "Contour system" 15' X 33'

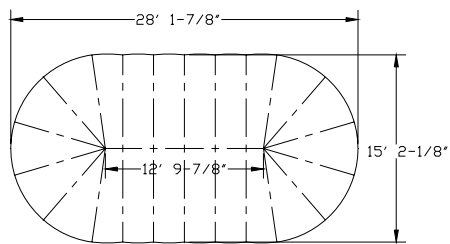

Oval Pool "Contour system" 15' X 28'

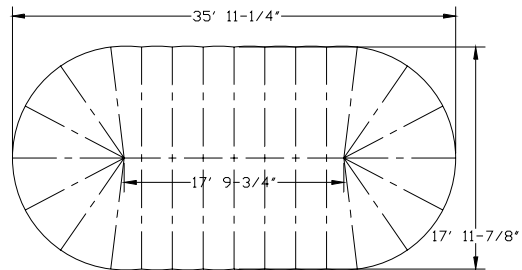

Oval Pool "Contour system" 18' X 36'

AQUA LEADER reserves the right to modify or alter any construction specifications without notice.

Manufactured by AQUA LEADER, 2370 de la Province Longueuil, QC, J4G 1G1

Revised 11/06